

# Car Frame Kit

Enquiry form

Hydraulic drive systems, acc. EN81-20 / 50

Rope drive systems, acc. EN 81-20 / 50

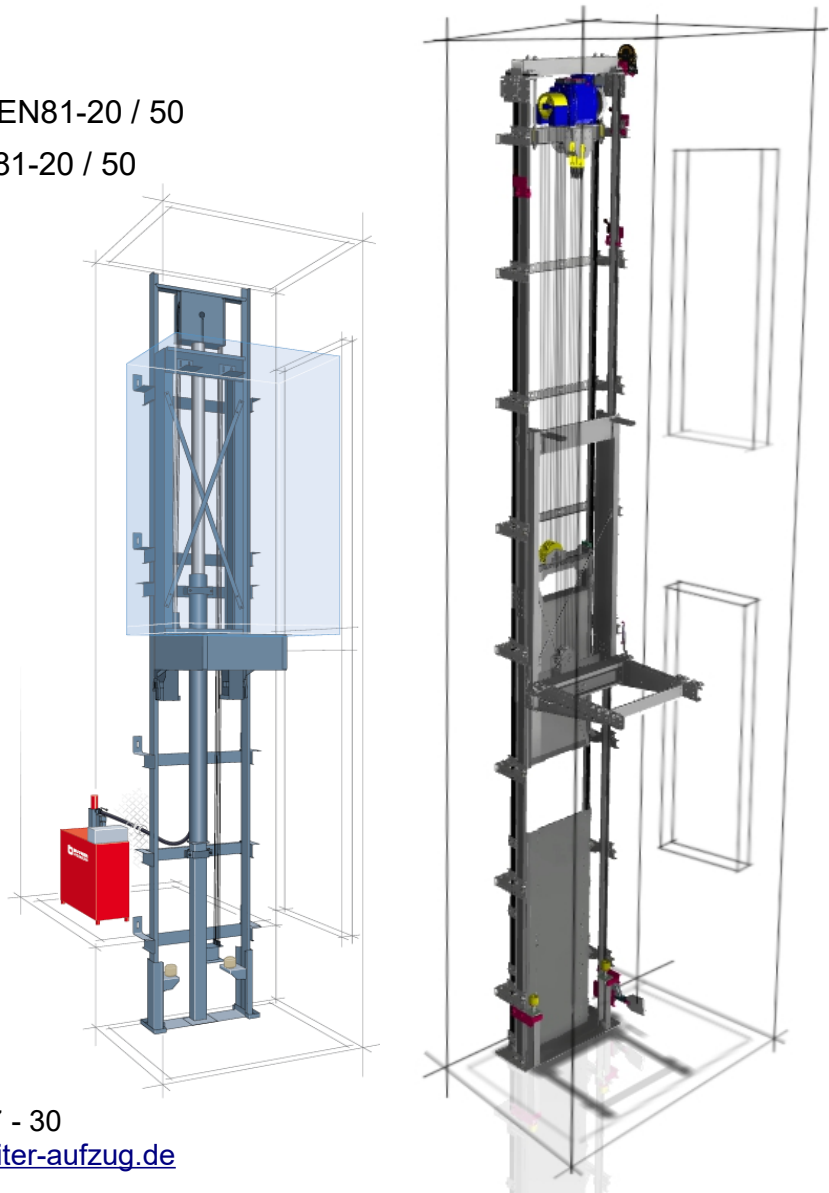
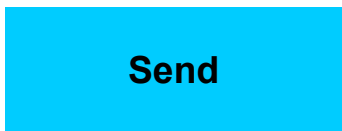

Please send the filled form

by Fax to: +49 (0) 8272 9867 - 30

by Mail to: [info@berchtenbreiter-aufzug.de](mailto:info@berchtenbreiter-aufzug.de)

## Table of contents

1. <a href="#">Enquiry Tiger System TG 2 MK II</a> .....	2
2. <a href="#">Enquiry Pluto Car Frame Kit, 1:1 Side Ram System - Type BR1 MK II</a> .....	3
3. <a href="#">Enquiry Pluto Car Frame Kit, 2:1 Side Ram System - Type BR2 MK II</a> .....	4
4. <a href="#">Enquiry Jupiter Car Frame Kit, 1:1 Tandem System - Type BT1</a> .....	5
5. <a href="#">Enquiry Jupiter Car Frame Kit, 2:1 Tandem System - Type BT2</a> .....	6
6. <a href="#">Enquiry Pluto Car Frame Kit, Rope Side Ram System - Type BRR</a> .....	7
7. <a href="#">Enquiry Car Frame Kit, Rope Central Ram System - Type ZZE-S</a> .....	8

# 1 Enquiry System Tiger TG 2 MKII

acc. EN 81-20 / 50

Company:

E-Mail:

Contact:

Phone:

Project:

Mobil:

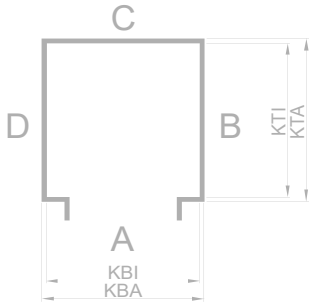

- Door at side A (main entrance)
- Door at side B
- Door at side C
- Door at side D
- Carframe at side B
- Carframe at side C
- Carframe at side D

**Passenger elevator**

Load capacity	Q	kg
Car weight 1)	PK	kg
Car travel	FK	mm
Car overtravel	RH	mm
Car speed	v	m/s
Car width internal	KBI	mm
Car width external	KB	mm
Car depth internal	KTI	mm
Car depth external	KT	mm
Car height internal	KHI	mm
Car height external	KH	mm
Car floor 2)	KU	mm
Car roof 3)	KD	mm
Shaft width internal	SB	mm
Shaft depth internal	ST	mm
Shaft pit	SG	mm
Shaft head	SK	mm
1st bracket spacing (pit)	B1	mm
Max. bracket spacing	B2	mm
1) Weight without frame, but incl. door(s) and travelling cable		
2) If not otherwise specified	100	mm
3) If not otherwise specified	50	mm
Dist. between guides	STM	mm
Dist. between guides rail axis and shaft wall	D	mm
Dist. between guides rail axis and outer car wall	F	mm

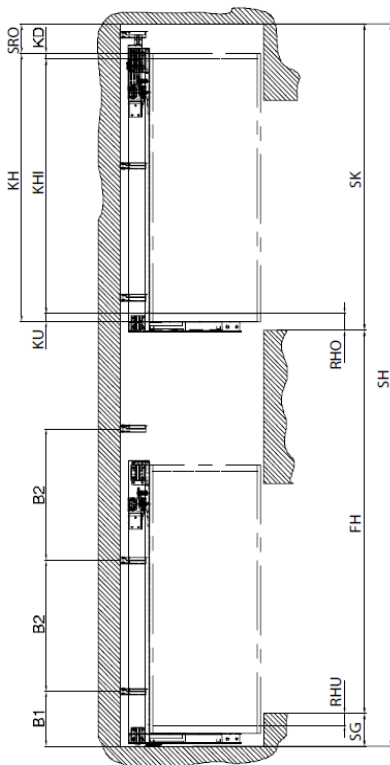

### Important

The car frame kit is always equipped with an overspeed governor and a progressive safety gear.

### Machine room

- Without machine room (standard)
- With machine room

### Overspeed governor

Anti-creeping device

- 12 V/DC
- 24 V/DC

Remote control (only possible when SG > 850 mm and with machine room)

- 24 V/DC
- 230 V/AC

### Ropes

- With ropes
- Without ropes

### Guide rails

- With guide rails
- Without guide rails

### Guide rail brackets

- With rail brackets
- Without rail brackets

### Leak oil bottle in the base unit

- With leak oil bottle
- Without leak oil bottle

## 2 Enquiry Pluto Car Frame Kit, 1:1 Side Ram System - Type BR1 MKII

acc. EN 81-20 / 50

Company:

E-Mail:

Contact:

Phone:

Project:

Mobil:

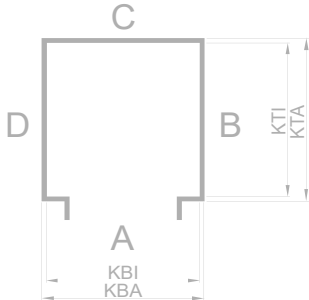

Door at side A (main entrance)

Door at side B

Carframe at side B

Door at side C

Carframe at side C

Door at side D

Carframe at side D

Passenger elevator

Freight elevator

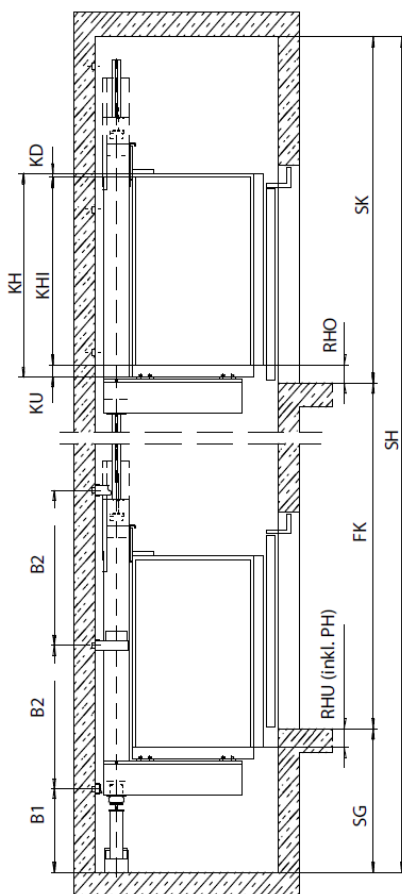

Load capacity	Q	kg
Car weight 1)	PK	kg
Car travel	FK	mm
Car overtravel	RH	mm
Car speed	v	m/s
Car width internal	KBI	mm
Car width external	KB	mm
Car depth internal	KTI	mm
Car depth external	KT	mm
Car height internal	KHI	mm
Car height external	KH	mm
Car floor 2)	KU	mm
Car roof 3)	KD	mm
Shaft width internal	SB	mm
Shaft depth internal	ST	mm
Shaft pit	SG	mm
Shaft head	SK	mm
1st bracket spacing (pit)	B1	mm
Max. bracket spacing	B2	mm
1) Weight without frame, but incl. door(s) and travelling cable		
2) If not otherwise specified	100	mm
3) If not otherwise specified	50	mm
Dist. between guides	STM	mm
Dist. between guides rail axis and shaft wall	D	mm
Dist. between guides rail axis and outer car wall	F	mm

### Content of supply

#### Guide rails

- T 90 / 75 / 16
- T 125 / 82 / 16
- Without guide rails

#### Guide rail brackets

- SE (individual brackets)
- SD (1-piece bracket)
- Without guide rail brackets

#### Type of car frame guides

- Sliding guides
- Roller guides

#### Fall protection

Damped pipe rupture valve

#### Leak oil bottle in the base unit

- With leak oil bottle
- Without leak oil bottle

### 3 Enquiry Pluto Car Frame Kit, 2:1 Side Ram System - Type BR2 MKII nach EN 81-20 / 50

Company:

E-Mail:

Contact:

Phone:

Project:

Mobil:

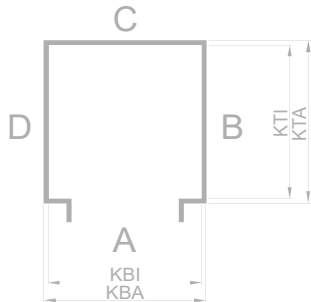

- Door at side A (main entrance)
- Door at side B
- Door at side C
- Door at side D
- Carframe at side B
- Carframe at side C
- Carframe at side D

- Passenger elevator
- Freight elevator

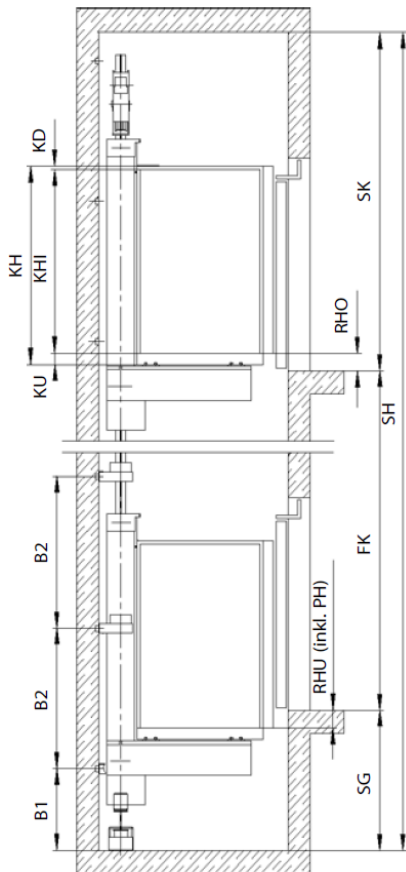

Load capacity	Q	kg
Car weight 1)	PK	kg
Car travel	FK	mm
Car overtravel	RH	mm
Car speed	v	m/s
Car width internal	KBI	mm
Car width external	KB	mm
Car depth internal	KTI	mm
Car depth external	KT	mm
Car hight internal	KHI	mm
Car hight external	KH	mm
Car floor 2)	KU	mm
Car roof 3)	KD	mm
Shaft width internal	SB	mm
Shaft depth internal	ST	mm
Shaft pit	SG	mm
Shaft head	SK	mm
1st bracket spacing (pit)	B1	mm
Max. bracket spacing	B2	mm
1) Weight without frame, but incl. door(s) and travelling cable		
2) If not otherwise specified	100	mm
3) If not otherwise specified	50	mm
Dist. between guides	STM	mm
Dist. between guides rail axis and shaft wall	D	mm
Dist. between guides rail axis and outer car wall	F	mm

#### Content of supply

##### Ropes

- With ropes
- Without ropes

##### Guide rails

- T 90 / 75 / 16
- T 125 / 82 / 16
- Without guide rails

##### Guide rail brackets

- SE (individual brackets)
- SD (1-piece bracket)
- Without guide rail brackets

##### Type of car frame guides

- Sliding guides
- Roller guides, but pulley with sliding guides
- Roller guides, also for the pulley

##### Leak oil bottle in the base unit

- With leak oil bottle
- Without leak oil bottle

##### Type of safety gear

- Roller safety gear up to 0.63 m/s
- Sliding wedge safety gear from 0.63

##### Safety gear tripping system

- Slack rope trip arm and switch with tripping device and damped pipe rupture valve (permissible up to 1.0 m/s)

- Cable L = 10 m
- Cable L = 20 m

- Overspeed governor incl. slack-rope trip arm with switch (with remote control 24 VDC)

- Overspeed governor incl. slack-rope trip arm with switch (with remote control 230 VAC)

- Overspeed governor supplied by customer, (but incl. trip lever on safety gear shaft)

# 4 Enquiry Jupiter Car Frame Kit, 1:1 Tandem System - Type BT1

nach EN 81-20 / 50

Company:

E-Mail:

Contact:

Phone:

Project:

Mobil:

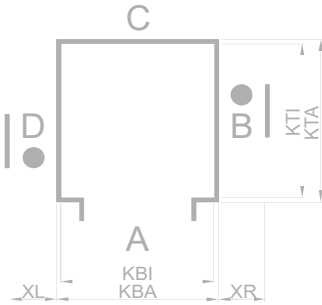

Door at side A (main entrance)

Cylinder position mirrored

Door at side C

Distance cabin outside to shaft wall (left and right side):

XL

XR

If not specified:  
XL = XR

Passenger elevator

Freight elevator

with lift truck in car

Load capacity	Q	kg
Car weight 1)	PK	kg
Car travel	FK	mm
Car overtravel	RH	mm
Car speed	v	m/s
Car width internal	KBI	mm
Car width external	KB	mm
Car depth internal	KTI	mm
Car depth external	KT	mm
Car height internal	KHI	mm
Car height external	KH	mm
Car floor	KU	mm
Car roof	KD	mm
Shaft width internal 1)	SB	mm
Shaft depth internal	ST	mm
Shaft pit	SG	mm
Shaft head	SK	mm
1st bracket spacing (pit)	B1	mm
Max. bracket spacing	B2	mm

1) Minimum dimension for existing shaft

## Content of supply

### Guide rails

- T 125 / 82 / 16
- T 140 / 102 / 28,6
- Without guide rails

### Yoke guide rails

- With yoke rails
- Without yoke rails

### Guide rail brackets

- With rail brackets
- Without rail brackets

### Leak oil bottle

- With leak oil bottle
- Without leak oil bottle

### Type of car frame guides

- Sliding guides
- Roller guides

### Pawl device

- Required
- Not required

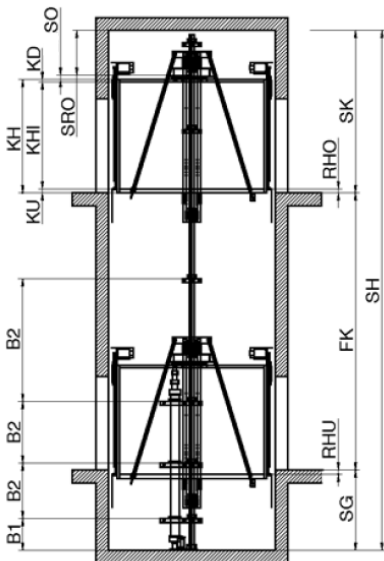

## Important

A maximum of one pipe-rupture valve may be used (with a rigid pipe between the cylinders).

The use of two pipe-rupture valves is not permitted!

The use of two pipe-rupture valves, with the associated uneven operation, can result in distortion of the frame and/or car.

## 5 Enquiry Jupiter Car Frame Kit, 2:1 Tandem System - Type BT2

Acc. EN 81-20 / 50

Company:

E-Mail:

Contact:

Phone:

Project:

Mobil:

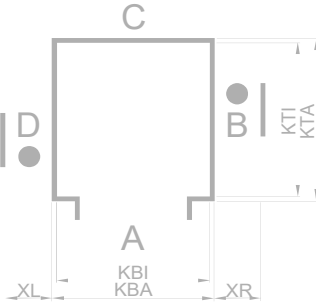

Door at side A (main entrance)

Cylinder position mirrored

Door at side C

Distance cabin outside to shaft wall  
(left and right side):

XL

XR

If not specified:  
XL = XR

Passenger elevator

Freight elevator

with lift truck in car

Load capacity	Q	kg
Car weight 1)	PK	kg
Car travel	FK	mm
Car overtravel	RH	mm
Car speed	v	m/s
Car width internal	KBI	mm
Car width external	KB	mm
Car depth internal	KTI	mm
Car depth external	KT	mm
Car height internal	KHI	mm
Car height external	KH	mm
Car floor	KU	mm
Car roof	KD	mm
Shaft width internal 1)	SB	mm
Shaft depth internal	ST	mm
Shaft pit	SG	mm
Shaft head	SK	mm
1st bracket spacing (pit)	B1	mm
Max. bracket spacing	B2	mm

1) Minimum dimension for existing shaft

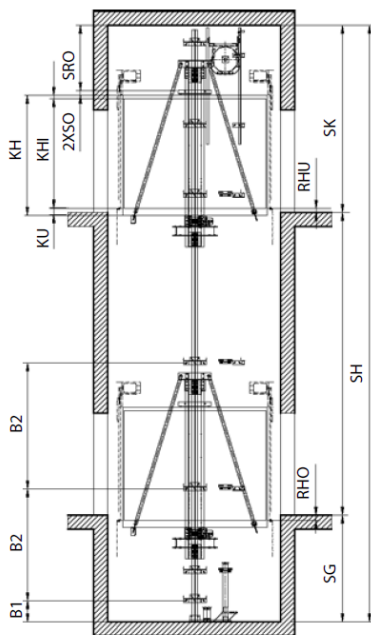

### Content of supply

#### Guide rails

- T 125 / 82 / 16
- T 140 / 102 / 28,6
- Without rails

#### Yoke guide rails

- With yoke rails
- Without yoke rails

#### Guide rail brackets

- With rail brackets
- Without rail brackets

#### Ropes

- With ropes
- Without ropes

#### Overspeed governor

- With overspeed governor
- Without overspeed governor  
(i.e. all customer-supplied)

#### Remote control

- 24 V/DC
- 230 V/AC
- Without remote control

#### Leak oil bottle

- With leak oil bottle
- Without leak oil bottle

#### Type of car frame guides

- Sliding guides
- Roller guides

#### Pawl device

- Required
- Not required

### Important

The car frame kit is always equipped with an overspeed governor and a progressive safety gear.

## 6 Enquiry Pluto Car Frame Kit, Rope Side Ram System - Type BRR

acc. EN 81-20 / 50

Company:

E-Mail:

Contact:

Phone:

Project:

Mobil:

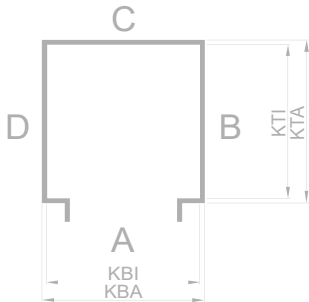

- Door at side A (main entrance)
- Door at side B
- Door at side C
- Door at side D
- Carframe at side B
- Carframe at side C
- Carframe at side D

- Passenger elevator
- Freight elevator

### Content of supply

#### Ropes

- With ropes
- Without ropes

#### Guide rails

- T 90 / 75 / 16
- T 125 / 82 / 16
- Without guide rails

#### Guide rail brackets

- SD (1-piece bracket)
- Without guide rail brackets

#### Type of car frame guides

- Sliding guides
- Roller guides, but counterweight with sliding guides
- Roller guides, also for the counterweight

#### Leak oil bottle in the base unit

- With leak oil bottle
- Without leak oil bottle

#### Safety gear tripping system

- Overspeed governor
- Overspeed governor supplied by customer
- 24 V/DC
- 230 V/AC
- Without remote control

Anti creeping device in case of low shaft pit

- 12 V/DC
- 24 V/DC

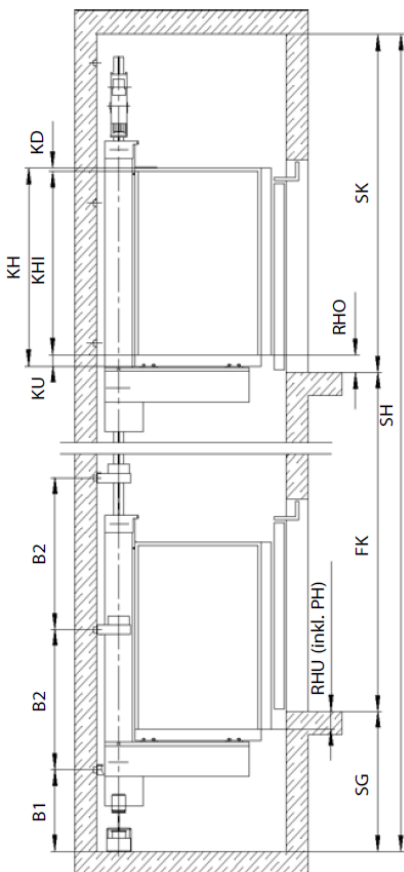

Load capacity	Q	kg
Car weight 1)	PK	kg
Car travel	FK	mm
Car overtravel	RH	mm
Car speed	v	m/s
Car width internal	KBI	mm
Car width external	KB	mm
Car depth internal	KTI	mm
Car depth external	KT	mm
Car height internal	KHI	mm
Car height external	KH	mm
Car floor 2)	KU	mm
Car roof 3)	KD	mm
Shaft width internal	SB	mm
Shaft depth internal	ST	mm
Shaft pit	SG	mm
Shaft head	SK	mm
1st bracket spacing (pit)	B1	mm
Max. bracket spacing	B2	mm
1) Weight without frame, but incl. door(s) and travelling cable		
2) If not otherwise specified	100	mm
3) If not otherwise specified	50	mm
Dist. between guides	STM	mm
Dist. between guides rail axis and shaft wall	D	mm
Dist. between guides rail axis and outer car wall	F	mm

### Important

The car frame kit is always equipped with an overspeed governor and a progressive safety gear.

# 7 Enquiry Car Frame Kit, Rope Central Ram System - Type ZZE-S

acc. EN 81-20 / 50

Company:

E-Mail:

Contact:

Phone:

Project:

Mobil:

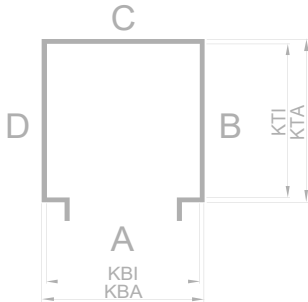

Door at side A (main entrance)

Engine at side B

Engine at side D

Passenger elevator

Freight elevator

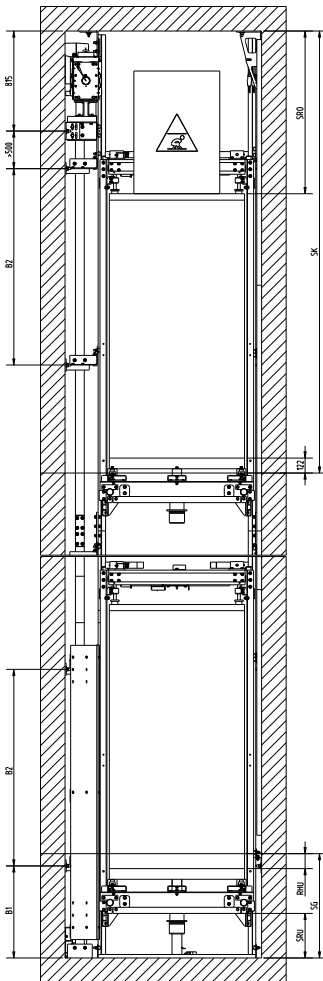

Load capacity	Q	kg
Car weight 1)	PK	kg
Car travel	FK	mm
Car overtravel	RH	mm
Car speed 2)	v	m/s
Car width internal	KBI	mm
Car width external	KB	mm
Car depth internal	KTI	mm
Car depth external	KT	mm
Car hight internal	KHI	mm
Car hight external	KH	mm
Car floor 3)	KU	mm
Car roof 4)	KD	mm
Shaft width internal	SB	mm
Shaft depth internal	ST	mm
Shaft pit	SG	mm
Shaft head	SK	mm
1st bracket spacing (pit)	B1	mm
Max. bracket spacing	B2	mm

1) Weight without frame, but incl.doors and travelling cable

2) Car speed up to 1,6 m/s possible (in the case of car speed above 1m/s the shaft dimensions will increase. These dimensions can be requested from our sales department)

3) If not otherwise specified: 100 mm

4) If not otherwise specified: 50 mm

5) Distance between guide rails and distanve to shaft wall will be set by Berchtenbreiter GmbH

Dist. between guides	STM	mm	by Berchtenb.
Dist. Engine side 5)	D	mm	by Berchtenb.
Dist side wo. engine 5)	F	mm	by Bberchenb.

## Content of supply

### Ropes

- With ropes
- Without ropes

### Guide rails

- With guide rails
- Without guide rails

### Guide rail brackets

- With guide rail brackets
- Without guide rail brackets

### Type of car frame guides

- Sliding guides
- Roller guides, but counterweight with sliding guides
- Roller guides, also for the counterweight

### Safety gear tripping system

- Overspeed governor
- Overspeed governor supplied by customer
- 24 V/DC
- 230 V/AC
- Without remote control

### Leak oil bottle in the base unit

- With leak oil bottle
- Without leak oil bottle

### Important

The car frame kit is always equipped with an overspeed governor and a progressive safety gear or an electronical progressive safety gear.

[info@berchtenbreiter-aufzug.de](mailto:info@berchtenbreiter-aufzug.de)

[www.berchtenbreiter-aufzug.de](http://www.berchtenbreiter-aufzug.de)

© 2024 by Berchtenbreiter Aufzugtechnik, D-86637 Rieblingen

All rights reserved

Data is provided for the purpose of product description only, and must not be considered as warranted characteristics in the legal sense. The information does not relieve users from the duty of conducting their own evaluations and tests. Because the products are subject to continual improvement, we reserve the right to amend the product specifications contained in this catalogue.